

Test report is for reference only.

TEST REPORT
for
C & Q TXLX-20180



Technical Specification

Polarization	RHCP
Frequency Range(GHz)	2-18
Gain(dBi)	-3.2 @2GHz
	4 @8GHz
	3.8 @18GHz
Beamwidth(°)	135 - 55
Axial Ratio(dB)	4 max
VSWR	2.5:1 Typ.
Connector	SMA-Female
Size(mm)	Φ61.5 x 50
Net Weight(Kg)	0.16 Around

Outline Drawing

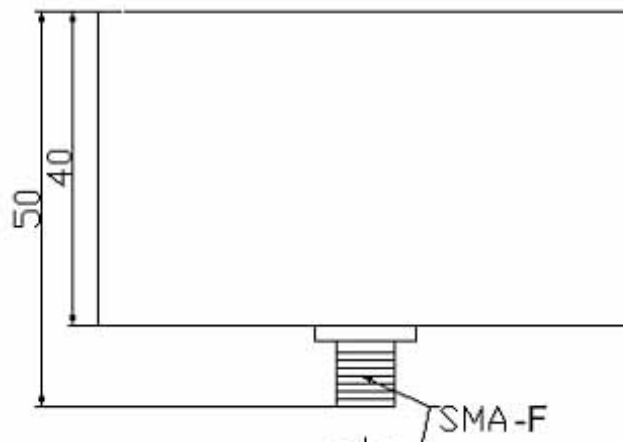

Mounting

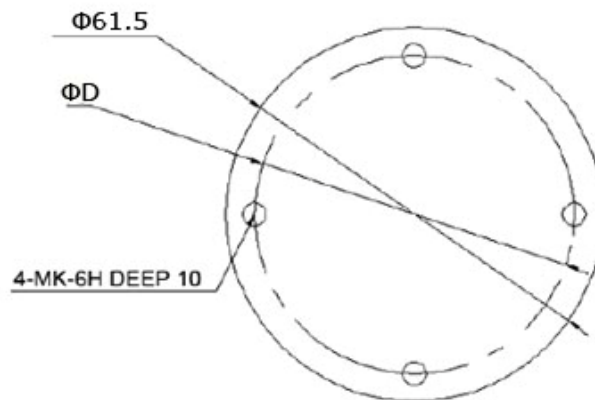

Model	D	K
JXTXLX-20180	40	4
JXTXLX-20180SA	40	4
JXTXLX-20180SB	34	3

Test Instruments

- HP8720D
- AV14812
- AV4033

Test Results

1. Gain

Frequency(GHz)	2	4	8	12	18
Gain(dBi)	-3.2	1.3	4	3.2	3.8

2. Axial Ratio

Frequency(GHz)	2	4	8	12	18
Axial Ratio(dB)	2.5	1.5	2	2.8	1.5

3. 3dB Beamwidth

Frequency(GHz)	E(°)	H(°)
2	102	135
4	80	89
8	55	62
12	72	79
18	78	95

4. VSWR

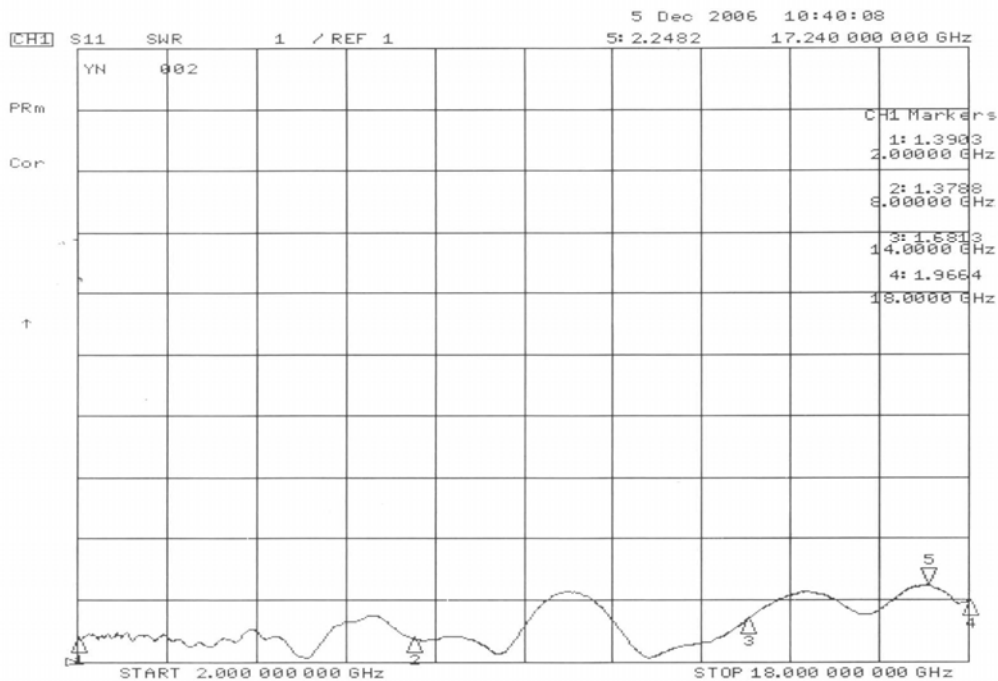

5. Pattern

Frequency: 2GHz

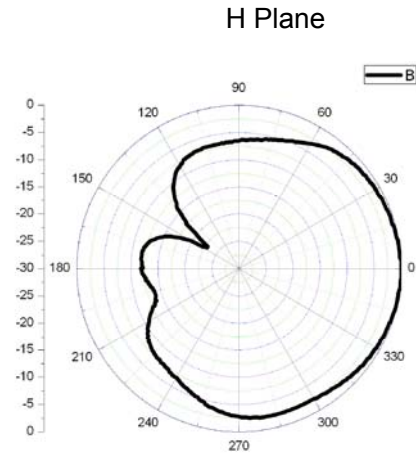
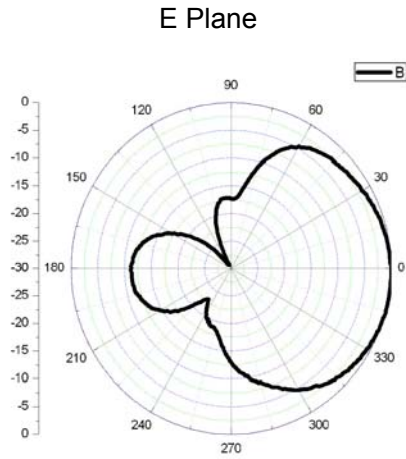

Frequency: 4GHz

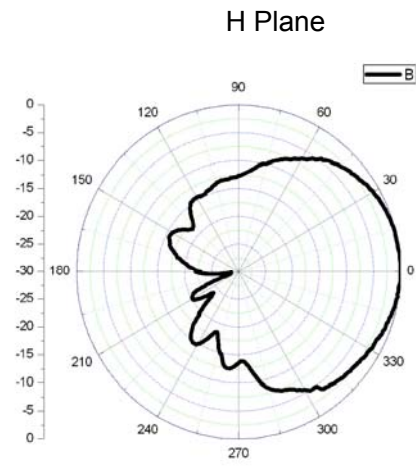
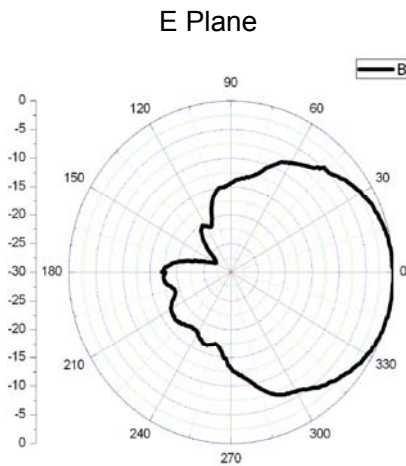

Frequency: 8GHz

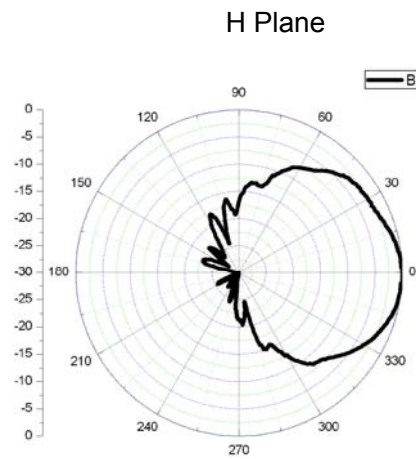
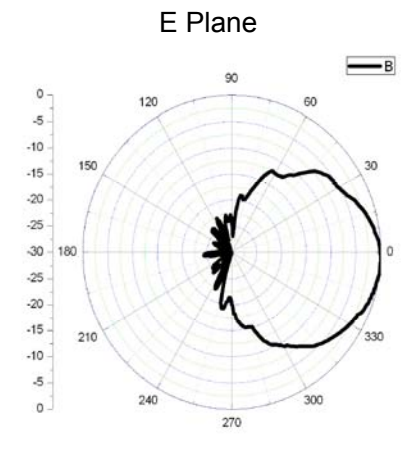

Frequency: 12GHz

E Plane

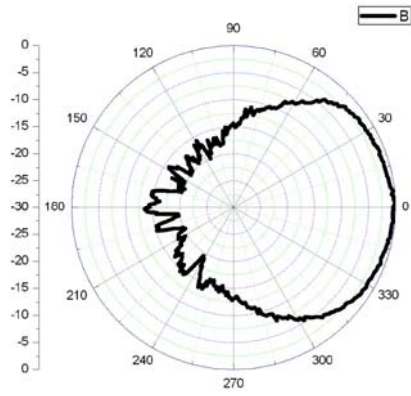

H Plane

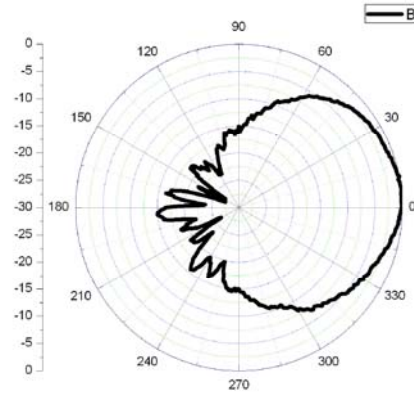

Frequency: 18GHz

E Plane

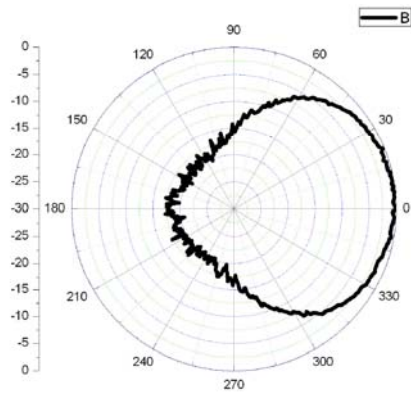

H Plane

